



ANLY TIMER

AMD MOTION DETECTOR



CHARACTERISTIC :

- Scanning speed ranges from 1 to 6000 rpm
- Optional shut-off feature when detecting excessive or insufficient speeds
- Abnormality and fault detection for pumps, clutches, transmissions, conveyer belts and motors
- DC 12V supplied for proximity switch or photoelectric switch
- Effective fault detections and preventions
- CE certified

SPECIFICATION :

Operating voltage	AC(V): 110, 220, 240
Allowable operating voltage range	85~110% of rated operating voltage
Rated frequency	50 / 60 Hz
Contact rating	250VAC 5A (resistive load)
Reset time	MAX 0.3S
Power consumption	Approx. 4VA
Life	Mechanical: 5,000,000 times Electrical: 100,000 times
Ambient temperature	-10 ~ +50°C
Ambient humidity	MAX 85%RH
Weight	Approx. 210g

TYPE SELECTION :

Type	AMD-N	AMD-NN	AMD-PN
Proximity switch type	NPN / PNP	NPN	PNP
Time range(Tacho)	0.1S (600~6000RPM) 1S (60~ 600RPM)	10S (6~60RPM) 60S (1~ 6RPM)	10M (0.1~1RPM)

CONNECTION :

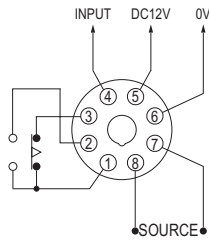

TIMING CHART :

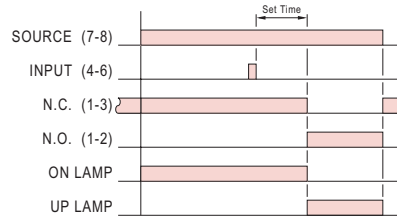

DIMENSIONS : (mm)

N type(Surface Mounting): Using 8PFA Socket

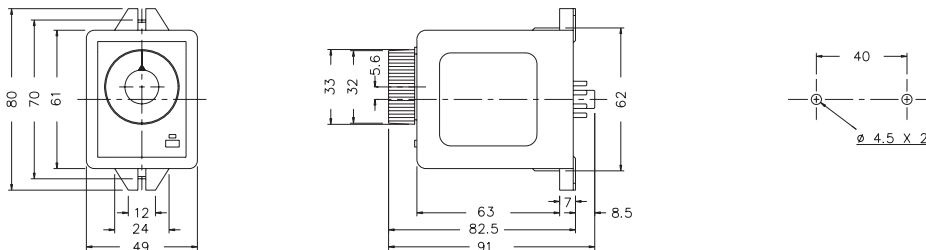

Y type(Flush Mounting): Using US-08 Socket or P3G-08 Socket

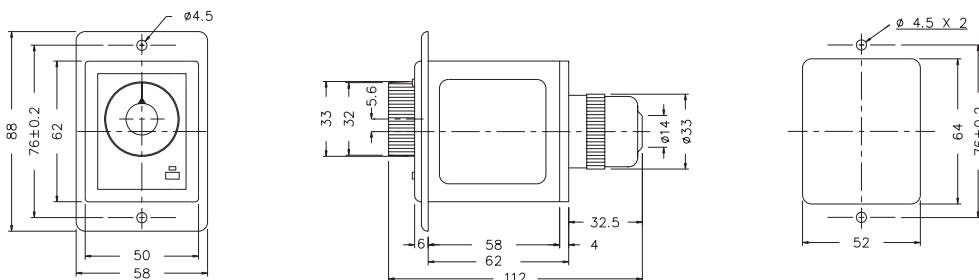

ANLY ELECTRONICS CO., LTD.

<http://www.anly.com.tw>

TAIWAN MAIN OFFICE : ANLY ELECTRONICS CO., LTD.

No.19, Lane 202, Fushou St., Shinjuang City, Taipei, Taiwan 242
TEL: +886-2-2996-3202 FAX: +886-2-2996-2017

MALAYSIA BRANCH : JUSTY ELECTRONICS (M) SDN, BHD.

No.1, Jalan 6/89B, Kawasan Perindustrian Trisegi, Batu 3 1/2 Off Jalan Sungei Besi, 57100 Kuala Lumpur, Malaysia
TEL: +60-3-7983-5758 FAX: +60-3-7981-5052

HONG KONG BRANCH : ANLY ELECTRONICS (HK) LTD.

Flat K, 13/F, Edward Mansion, 141 Prince Edward Road W., Kowloon, Hong Kong
TEL: +852-2397-2505 FAX: +852-2397-6080

SHANGHAI BRANCH : ANLY TECHNOLOGY (WUXI) CO., LTD.

Room 13G, No.831, Xinzha Rd., Jingan District, Shanghai, China 200041
TEL: +86-21-6218-3300 FAX: +86-21-6217-5911