



APT-8S / APT-9S

WEEKLY PROGRAMMABLE TIMER

User's Manual

SAFETY PRECAUTION This manual uses the following symbols to ensure safe operation of this timer.

- ⚠ WARNING** Warnings are indicated when mishandling this controller might result in death or serious injury to user.
- ⚠ CAUTION** Cautions are indicated when mishandling this controller might result in minor injury to the user, or only physical damage to the timer.

⚠ WARNING

- Note this incorrect wiring of this controller can damage it and lead to other hazards. Make sure the controller has been correctly wired before turning the power ON.
- Before wiring, or removing / mounting the controller, be sure to turn the power OFF. Failure to do so might cause electric shock.
- Do not touch electrically charged parts such as the power terminals. Doing so might cause electric shock.
- Do not disassemble the controller. Doing so might cause electric shock or faulty operation.

⚠ CAUTION

- Use the controller within the operating ranges recommended in the specification (temperature, humidity, voltage, shock, mounting direction, atmosphere and etc.). Failure to do so might cause fire or faulty operation.
- Firmly tighten the terminal screws. Insufficient tightening of terminal screws might cause electric shock or fire.
- Press reset before use after turning the battery on or replace the battery.

RESTRICTIONS ON USE

When using this product in applications that require particular safety or when using this product in important facilities, please pay attention to the safety of the overall system and equipment. Install fail-safe mechanisms, perform redundancy checks and periodic inspections and adopt other appropriate safety measures when it is necessary. This product is rated at Class II □.

SPECIFICATIONS

Operating voltage	AC/DC : 12 ~ 48V / AC/DC : 100 ~ 240V
Allowable operating voltage range	85 ~ 110% of rated operating voltage
Rated frequency	50 / 60 Hz
Contact rating	240VAC 7A(N.O.), 240VAC 5A(N.C.) Resistive load
Status Indicator	POWER - Red / RELAY ON - Green
Power consumption	Approx. 3.3VA
Life	Mechanical : 5,000,000 times / Electrical : 100,000 times
Ambient temperature	-10 ~ +50 °C
Ambient humidity	MAX 85% RH
Weight	Approx. 170g

BUTTON and SWITCH FUNCTIONS

- **DAY** : Day of Week Setup
- **HR** : Hour Setup
- **MIN** : Minute Setup
- **SEC** : Second Setup
- **MODE** : Mode Selection
- **PROG.** : Program Selection
- **START** : Start Mode
- **CLEAR** : Clear Setting
- **12/24H** : 12H or 24H
- **+1H** : Daylight-Saving-Time
- **MAN** : Manual Override
- **RESET** : Program Reset
- **TIMER** : Timer Control
- **PULSE** : Pulse Output
- **min** : Twin Timer Unit - Hr : Min
- **sec** : Twin Timer Unit - Min : Sec
- **ON** : Power / Battery On
- **OFF** : Power / Battery Off

OPERATING FLOWCHART

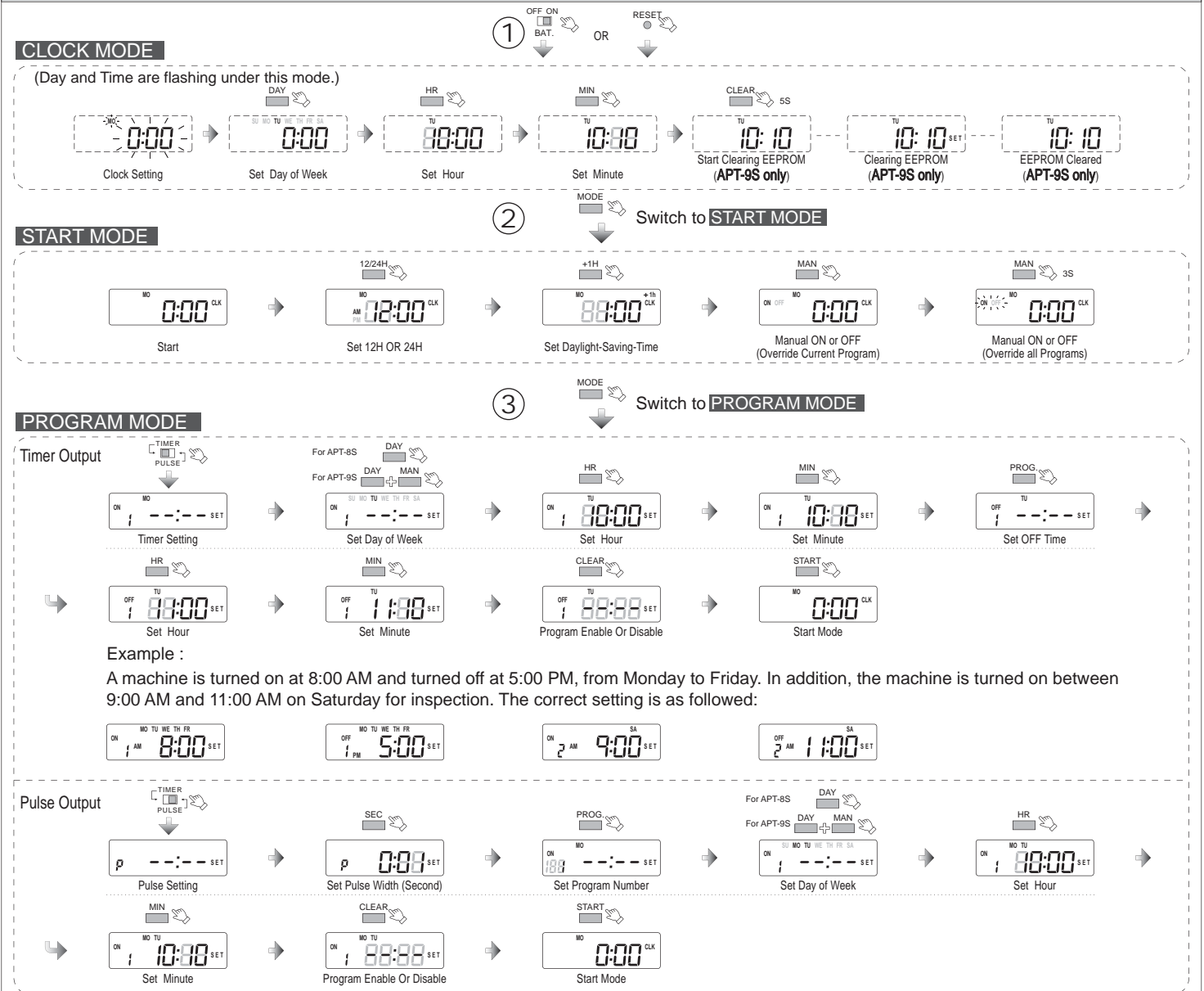

Example :

A factory has a buzzer to remind workers of their work time and break time . The buzzer is activated at 8:00, 12:00, 13:00, and 17:00, from Monday to Saturday. The buzzer duration is 10-second. The correct setting is as followed:



HOLIDAY SUSPENSION MODE

(This step is optional.)



TWIN TIMER MODE

(This step is optional. Please note, when Twin Timer Mode is enabled, the program will be disabled.)

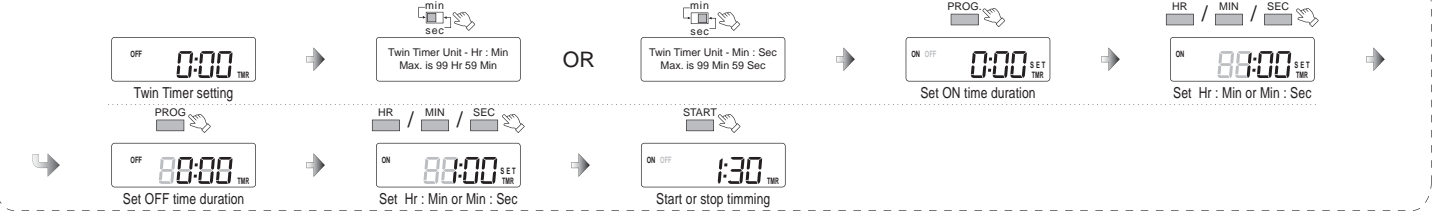

Switch to CLOCK MODE

CONNECTION

When APT and the load have separate power source

N Type

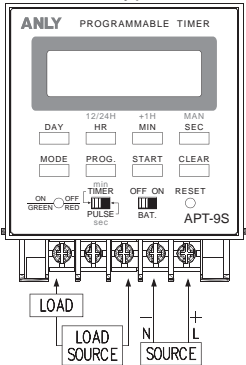

When APT and the load share the same power source

N Type

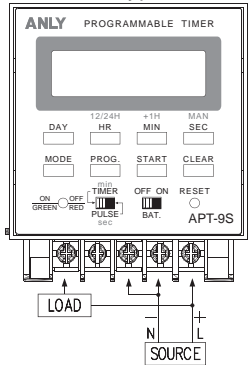

POWER BACKUP FEATURE

The timer can retain clock operation and program memory when the external power fails. Under any power failure, the contact position will be held at OFF position. When the power is restored, the output relay will restore contact status according to the program.(See chart at right)

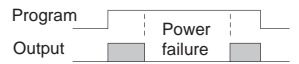

PROGRAM OVERLAPPING TIMEING CHART

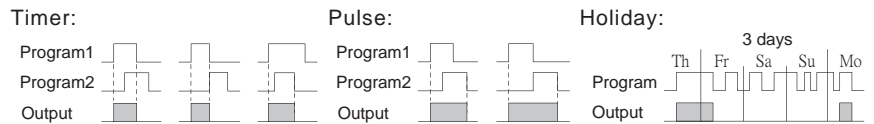

BATTERY CHANGE

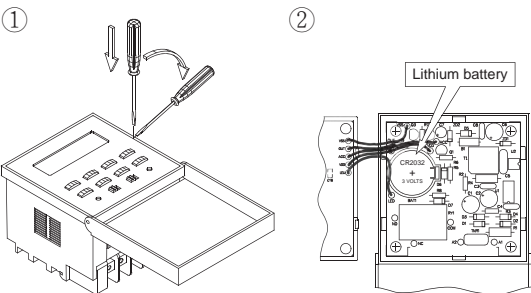

CONVERT Y TYPE (Flush Mounting) TO N TYPE (Surface Mounting)

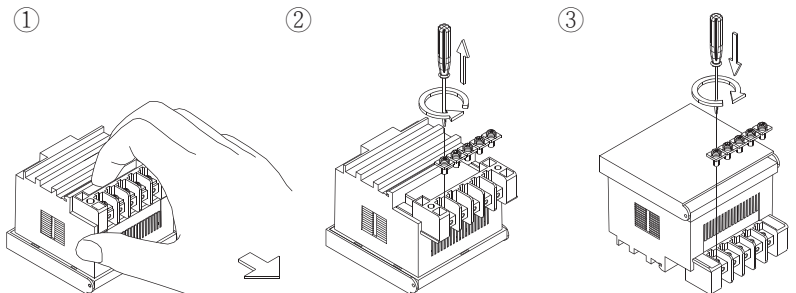

CONVERT N TYPE (Surface Mounting) TO Y TYPE (Flush Mounting)

